

MATERIAL:	NAME:	DATE:	 TOOLMEX™ SOLE PROPERTY OF TOOLMEX INDUSTRIAL SOLUTIONS
HARDNESS:	WEIGHT: 2153.075 KG	DRAWN: T. THACH	
UNLESS OTHERWISE SPECIFIED: DIMENSIONS ARE IN MILLIMETERS TOLERANCES: .X ±0.25 .XX ±0.12 ANGULARITY: ±0°30'		ENG APPR.	TITLE 4-JAW EX/HD OIL COUNTRY CHUCK A2-15, 48" (1200MM) SIZE DWG. NO. REV B 3-859-4815P PRE
INTERPRET GEOMETRIC TOLERANCING PER: Y1999-2001		MFG APPR.	
		Q.A. APPR.	
		SALES APPR.	
		CONFIDENTIAL THIS DRAWING AND THESE SPECIFICATIONS ARE THE SOLE PROPERTY OF TOOLMEX INDUSTRIAL SOLUTIONS, AND SHALL NOT BE REPRODUCED, OR COPIED IN PART OR AS A WHOLE WITHOUT THE EXPRESS WRITTEN PERMISSION OF TOOLMEX INDUSTRIAL SOLUTIONS IS PROHIBITED.	
		DO NOT SCALE DRAWING SHEET 1 OF 3	

8 7 6 5 4 3 2 1

CARACTERISTICAS TECNICAS	
Torque on key	70 daNm
Clamping force per jaw	4750 daN
Max. Speed Rotation	509 r.p.m

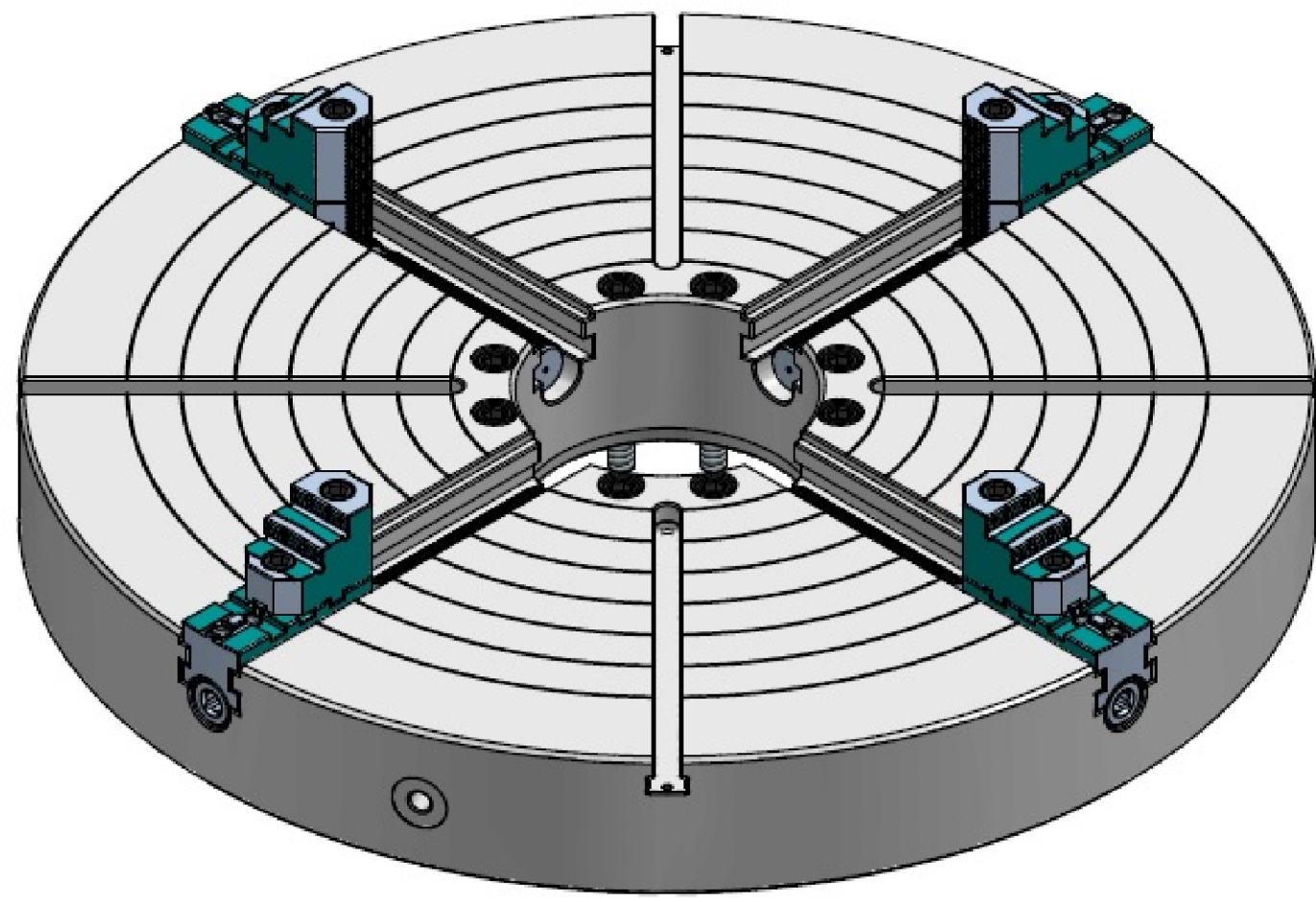
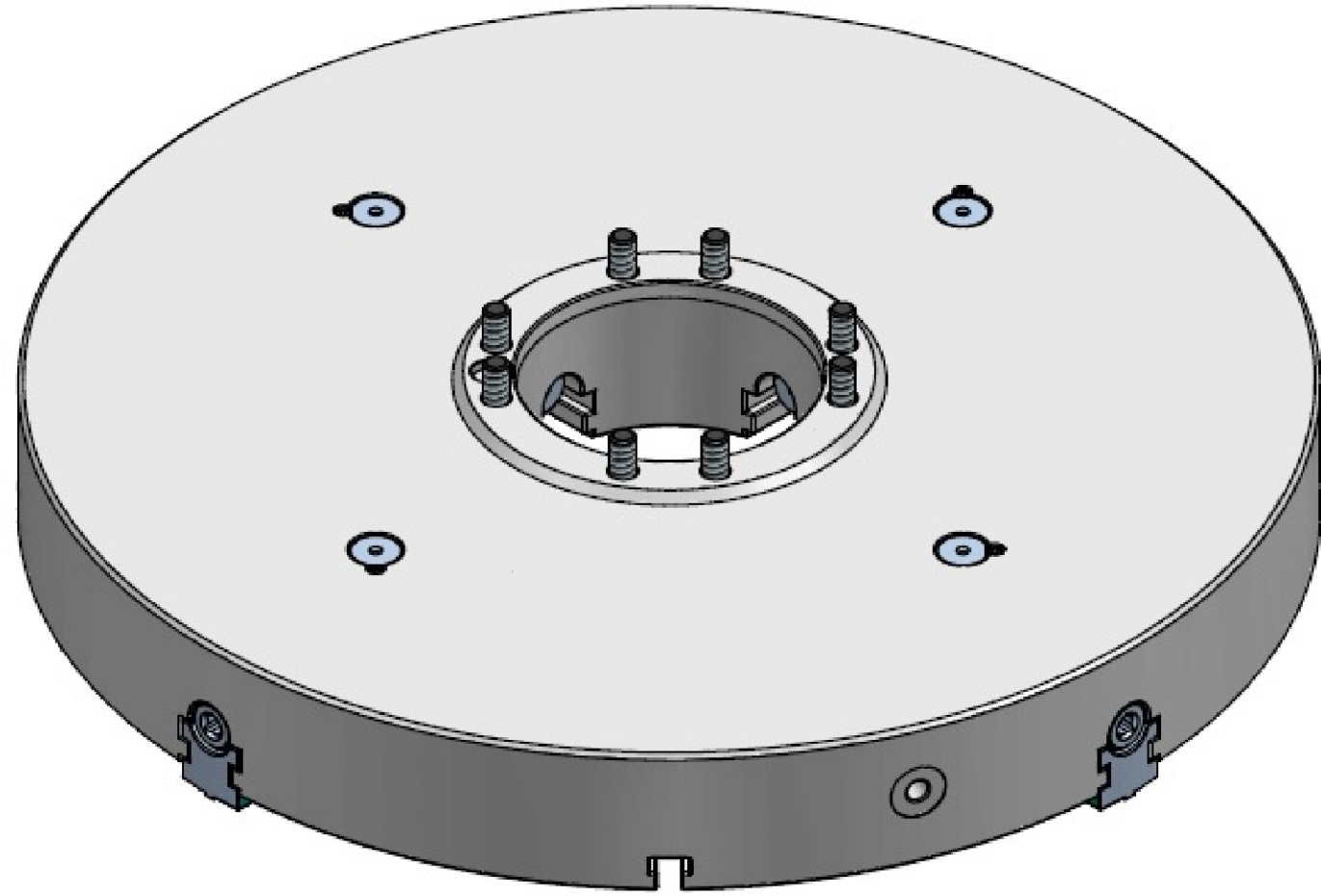

MATERIAL:		NAME	DATE	 TOOLMEX™ SOLE PROPERTY OF TOOLMEX INDUSTRIAL SOLUTIONS
HARDNESS:	WEIGHT: 2153.075 KG	DRAWN	T. THACH 02-22-2022	
UNLESS OTHERWISE SPECIFIED: DIMENSIONS ARE IN MILLIMETERS TOLERANCES: .X ±0.25 .XX ±0.12 ANGULARITY: ±0°30'		ENG APPR.		
		MFG APPR.		
INTERPRET GEOMETRIC TOLERANCING PER: Y1999-2001		Q.A. APPR.		
		SALES APPR.		
		CONFIDENTIAL THIS DRAWING AND THESE SPECIFICATIONS ARE THE SOLE PROPERTY OF TOOLMEX INDUSTRIAL SOLUTIONS, AND SHALL NOT BE REPRODUCED, OR COPIED IN PART OR AS A WHOLE WITHOUT THE EXPRESS WRITTEN PERMISSION OF TOOLMEX INDUSTRIAL SOLUTIONS IS PROHIBITED.		TITLE 4-JAW EX/HD OIL COUNTRY CHUCK A2-15, 48" (1200MM)
		SIZE B	DWG. NO. 3-859-4815P	REV PRE
DO NOT SCALE DRAWING			SHEET 2 OF 3	

8 7 6 5 4 3 2 1

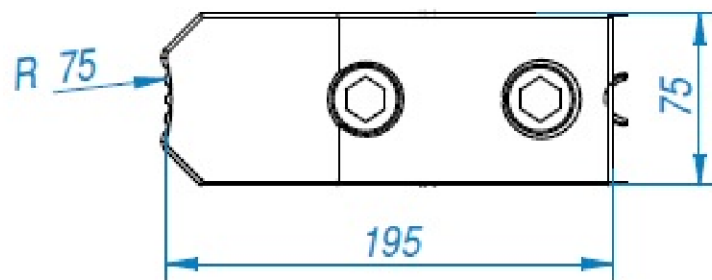
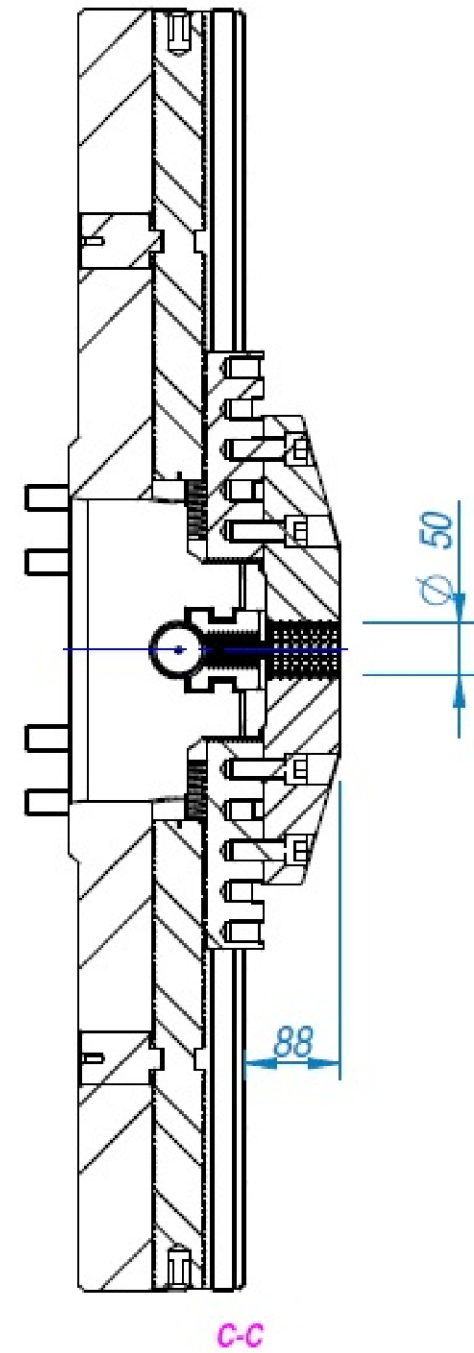
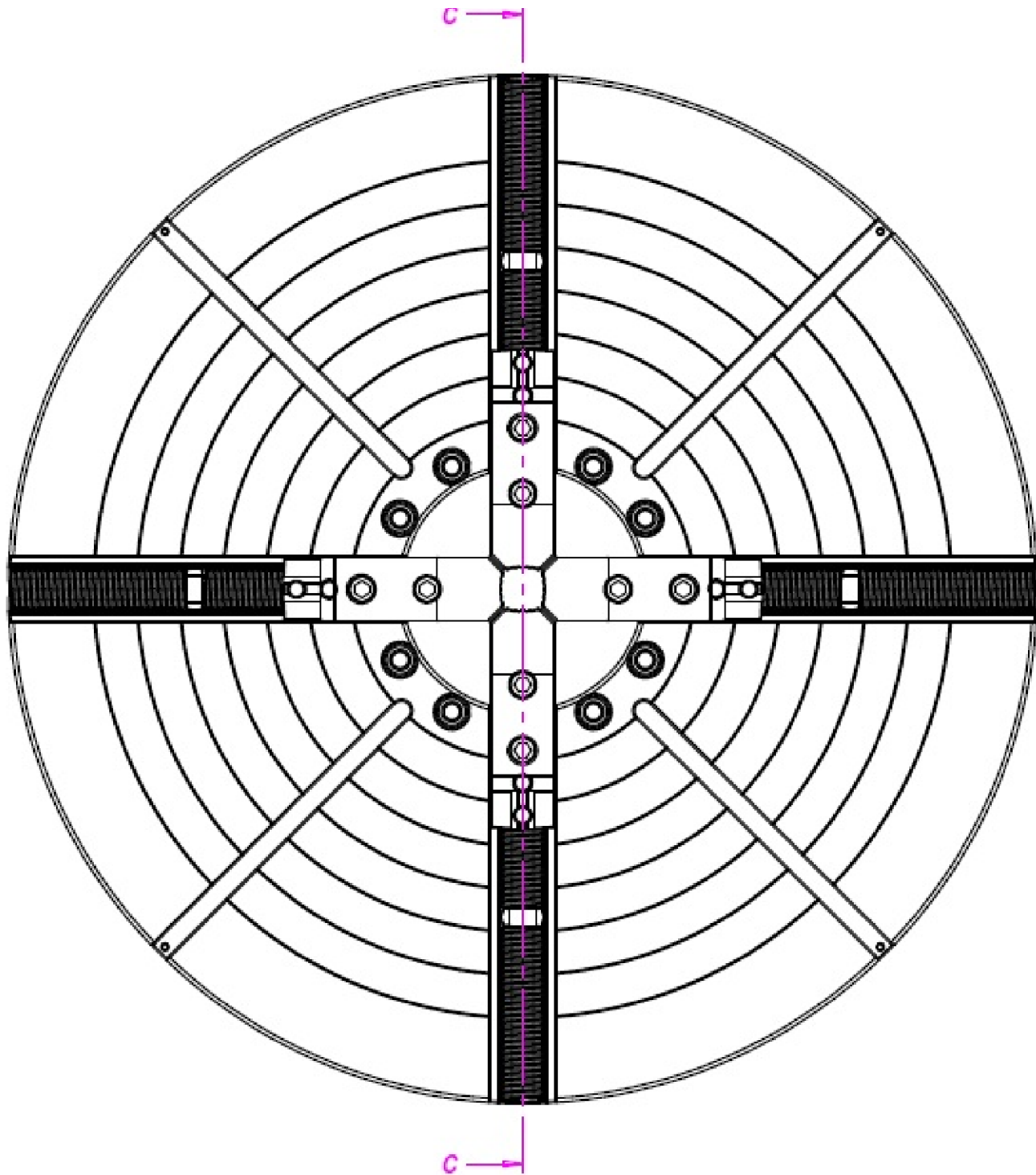

MATERIAL:	WEIGHT: 2153.075 KG	DRAWN	NAME	DATE	 TOOLMEX™ SOLE PROPERTY OF TOOLMEX INDUSTRIAL SOLUTIONS
HARDNESS:		ENG APPR.	T. THACH	02-22-2022	
UNLESS OTHERWISE SPECIFIED: DIMENSIONS ARE IN MILLIMETERS TOLERANCES: .X ±0.25 .XX ±0.12 ANGULARITY: ±0°30'		MFG APPR.			
		Q.A. APPR.			
INTERPRET GEOMETRIC TOLERANCING PER: Y1999-2001		SALES APPR.			TITLE 4-JAW EX/HD OIL COUNTRY CHUCK A2-15, 48" (1200MM)
		CONFIDENTIAL THIS DRAWING AND THESE SPECIFICATIONS ARE THE SOLE PROPERTY OF TOOLMEX INDUSTRIAL SOLUTIONS, AND SHALL NOT BE REPRODUCED, OR COPIED IN PART OR AS A WHOLE WITHOUT THE EXPRESS WRITTEN PERMISSION OF TOOLMEX INDUSTRIAL SOLUTIONS IS PROHIBITED.			SIZE DWG. NO. REV B 3-859-4815P PRE
					DO NOT SCALE DRAWING